

## CP 3085 MT 3~ 432 Technical specification

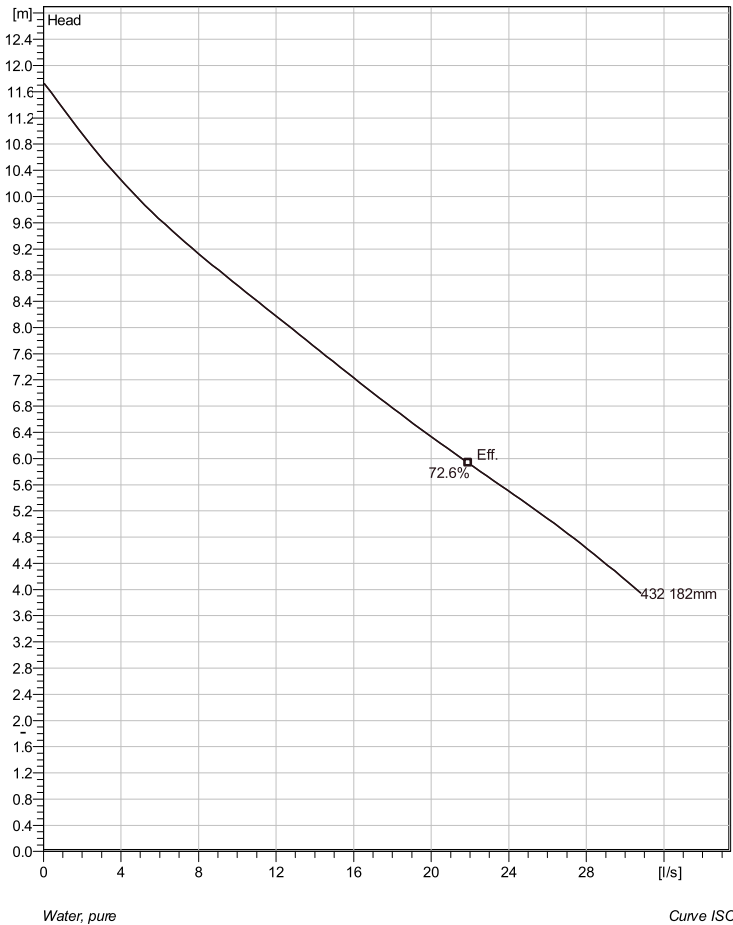

Note: Picture might not correspond to the current configuration.

### General

Shrouded single or multi-channel impeller pumps with large throughlets and single volute pump casing for liquids containing solids and fibres. Cast iron design with double sealing technology. Some models available as stainless steel versions.

### Impeller

Impeller material	Grey cast iron
Discharge Flange Diameter	80 mm
Suction Flange Diameter	80 mm
Impeller diameter	182 mm
Number of blades	1
Throughlet diameter	76 mm

### Motor

Motor #	C3085.183 15-10-4AL-W 2KW Standard
Stator variant	67
Frequency	50 Hz
Rated voltage	400 V
Number of poles	4
Phases	3~
Rated power	2 kW
Rated current	4.5 A
Starting current	19 A
Rated speed	1380 rpm
Power factor	
1/1 Load	0.86
3/4 Load	0.81
1/2 Load	0.70
Motor efficiency	
1/1 Load	74.0 %
3/4 Load	77.5 %
1/2 Load	78.0 %

### Configuration

### Installation: P - Semi permanent, Wet

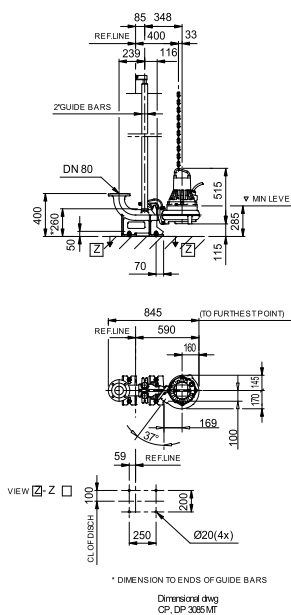

Project	Project ID	Created by	Created on 1/31/2019	Last update
---------	------------	------------	-------------------------	-------------

## CP 3085 MT 3~ 432

### Performance curve

#### Pump

Discharge Flange Diameter	80 mm
Suction Flange Diameter	80 mm
Impeller diameter	182 mm
Number of blades	1
Throughlet diameter	76 mm

#### Motor

Motor #	C3085.183 15-10-4AL-W 2KW
Stator variant	67
Frequency	50 Hz
Rated voltage	400 V
Number of poles	4
Phases	3~
Rated power	2 kW
Rated current	4.5 A
Starting current	19 A
Rated speed	1380 rpm

Power factor	
1/1 Load	0.86
3/4 Load	0.81
1/2 Load	0.70
Motor efficiency	
1/1 Load	74.0 %
3/4 Load	77.5 %
1/2 Load	78.0 %

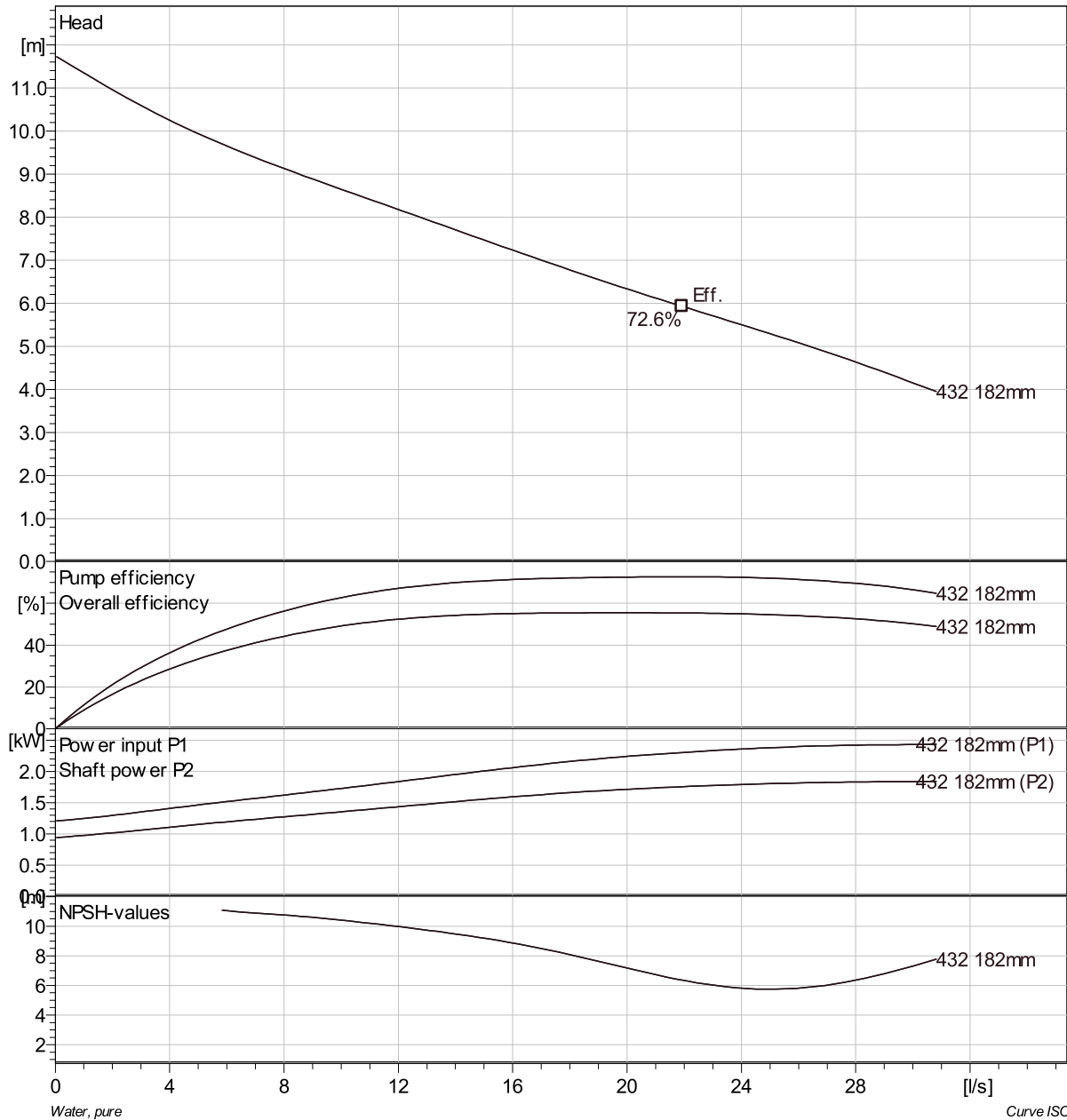

## CP 3085 MT 3~ 432 Duty Analysis

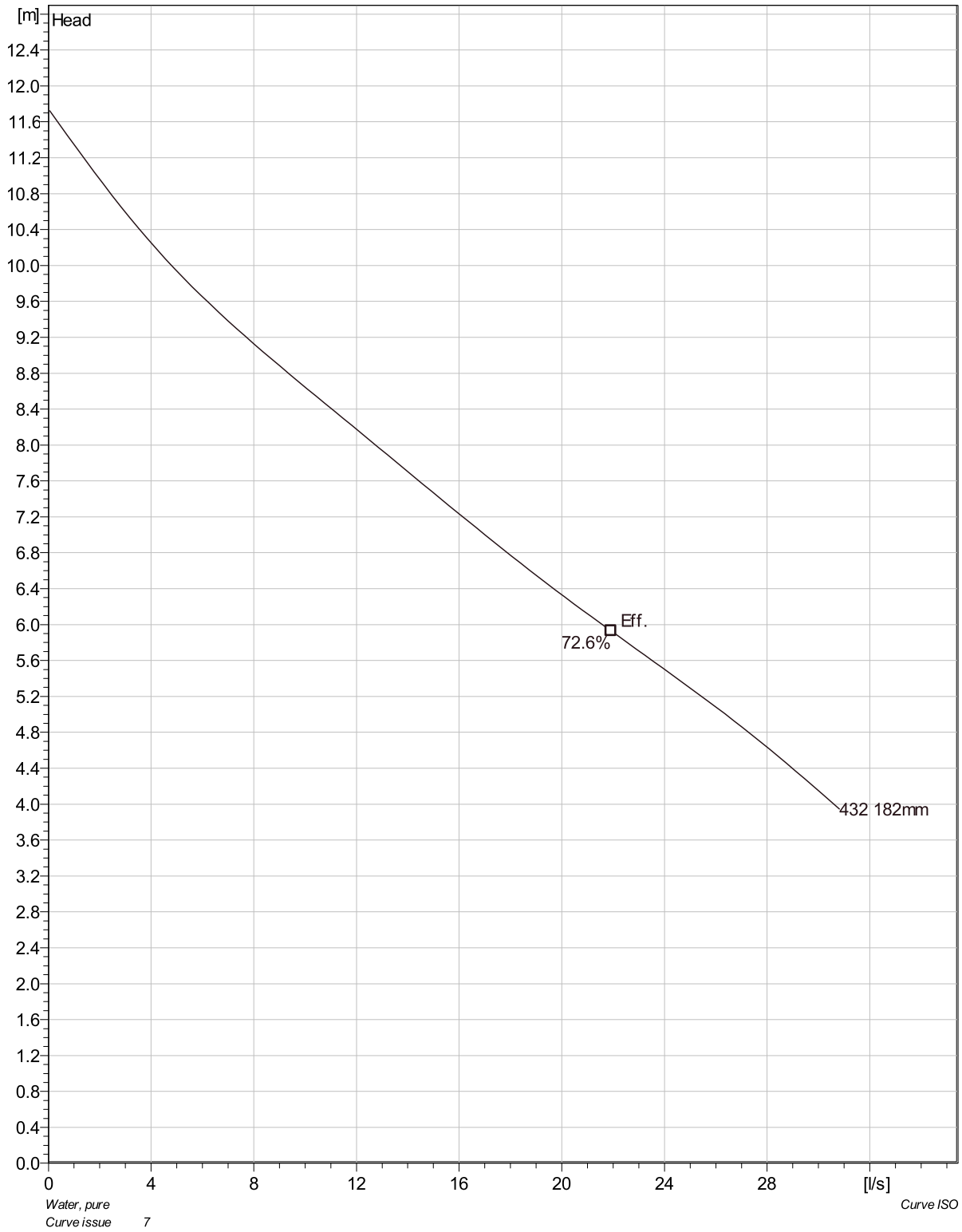

Project	Project ID	Created by	Created on	Last update
			1/31/2019	

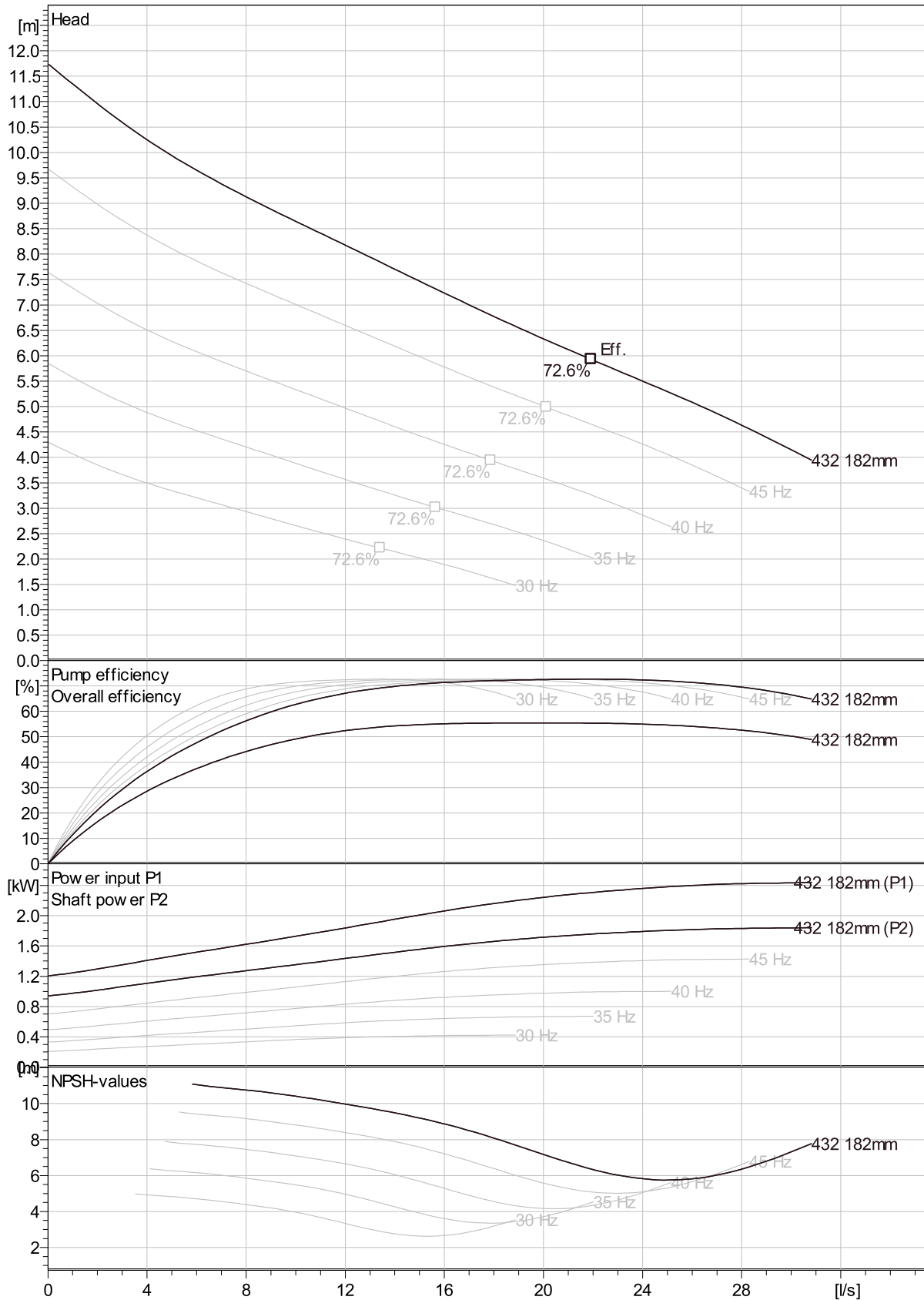

Curve ISO

Project	Project ID	Created by	Created on	Last update
			1/31/2019	

## CP 3085 MT 3~ 432 VFD Analysis

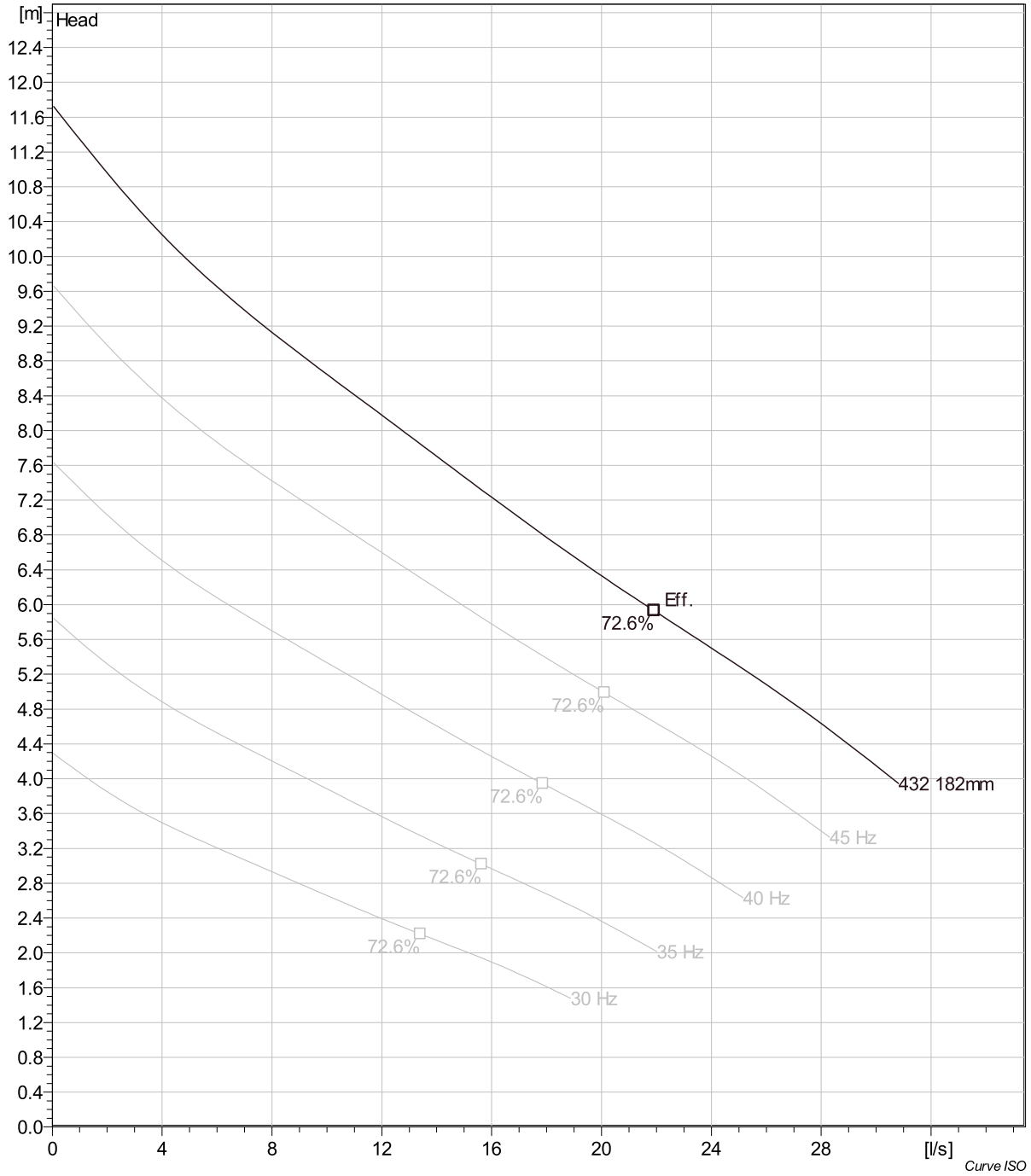

Project	Project ID	Created by	Created on	Last update
			1/31/2019	

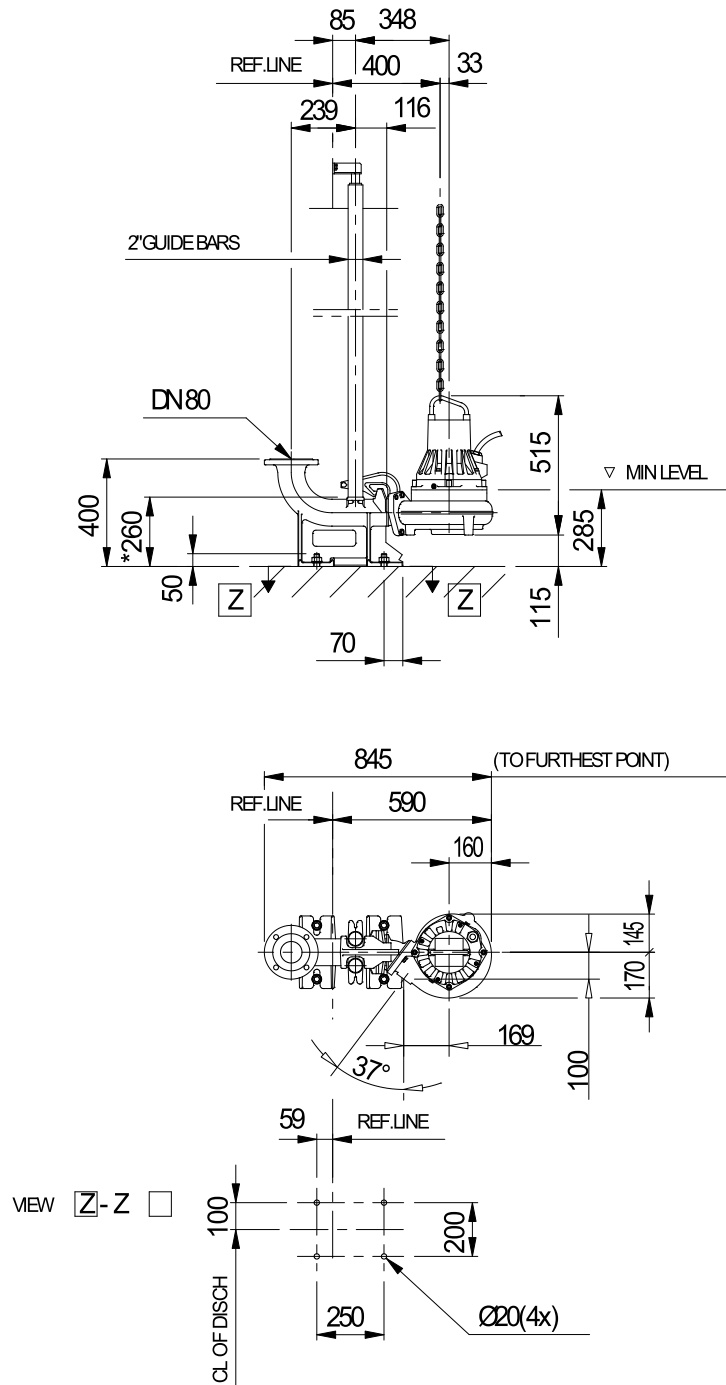

\* DIMENSION TO ENDS OF GUIDE BARS

Dimensional dwg  
CP, DP3085 MT

Project	Project ID	Created by	Created on	Last update
			1/31/2019	